

Intellectual Property

Introduction to patenting and technology protection

Jim Baker, Ph.D.
Registered Patent Agent
Director
Office of Technology and Economic Development

MichiganTech *Technology and Economic Development*

What is Intellectual Property?

- Intellectual property can be defined as products of individuals' minds - products that result from intellectual, creative processes.
- Legal Forms of Intellectual Property Include:
 - **Patents**, Trademarks, Copyrights and Trade Secrets
- Practical forms of Intellectual Property Include:
 - Ideas -> Inventions -> Innovations

MichiganTech *Technology and Economic Development*

Time Horizons for Protection

- Patent
 - 20 years from filing date
- Copyright
 - 70 years from death of author
- Trade Secret
 - As long as you can keep it a secret

MichiganTech *Technology and Economic Development*

Basis for a Patent System

- *U.S. Constitution: "to promote the progress of science and useful arts by securing for limited times to authors and inventors the exclusive right to their respective writings and discoveries"*
- *Enrich the fund of public knowledge*
 - An invention is of no good to humanity until it is disclosed/used but once it is used it can be readily copied by others.
 - Granting a temporary monopoly will encourage disclosure and support commerce
 - Reward/incentive for investment of time and money
 - Encouraging "inventing around"
 - Requirement for disclosure of preferred embodiment.

MichiganTech *Technology and Economic Development*

Idea to Innovation

- Idea
 - Basic concept or general solution to a problem.
- Invention
 - Specific solution that can be described in a patent claim.
- Innovation
 - An invention that has achieved commercial potential.

MichiganTech Technology and Economic Development

Idea

- “There should be a way to smooth out snow trails. You could do it with a machine like a tractor but works better than the existing drag systems”

MichiganTech Technology and Economic Development

Invention

U.S. Patent 6,671,983

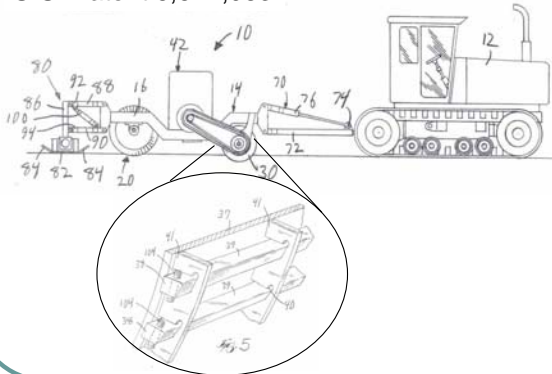

MichiganTech Technology and Economic Development

Innovation...



MichiganTech Technology and Economic Development

Basic Protection Considerations

- Idea to Invention
 - Is the technology patentable?
- Invention to Innovation
 - How strong is the patent likely to be?
 - What is the size of the market for the technology?
 - Is that market enhanced by protection of the technology?

MichiganTech Technology and Economic Development

Commercial Opportunity Assessment

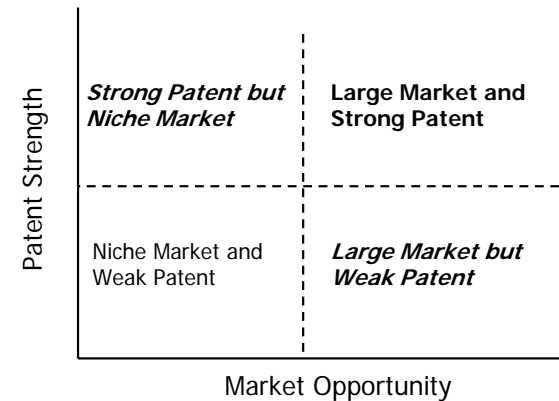

MichiganTech Technology and Economic Development

If not patent then what?

- Trade Secret
- Know-how
- Back to the drawing board
- Run to the market...

MichiganTech Technology and Economic Development

Types of Patents

- Utility patents
 - may be granted to anyone who invents or discovers any new, useful, and non-obvious process, machine, article of manufacture, or composition of matter, or any new and useful improvement thereof.
- Design patents
 - may be granted to anyone who invents a new, original, and ornamental design for an article of manufacture.
- Plant patents
 - may be granted to anyone who invents or discovers AND asexually reproduces any distinct and new variety of plant.

MichiganTech Technology and Economic Development

Requirements for patentability

- Novel
 - The object of the patent must be new (not published, previously available for purchase, or available to the public in any way).
- Non-Obvious
 - The invention must not be obvious to those “skilled in the art”.
- Useful
 - Must satisfy some productive purpose.

MichiganTech Technology and Economic Development

Patenting Algorithms and Computer Software

- Traditionally software was protected via copyright.
- Patenting of software is an evolving area.
- Cannot patent a “natural phenomenon” or a “mathematical result in pure form or number” - e.g. a rule of nature, a mathematical equation as itself, or the pure results of an equation.

MichiganTech Technology and Economic Development

Algorithms and Software (cont.)

- Rules Applied by U.S. PTO
 - Series of steps to be performed on a computer AND meets either of the following conditions:
 - Performs independent physical acts (e.g. controller software as part of the controlled system)
 - Manipulates data representing physical objects or activities to achieve a practical application (i.e. it must do more than calculate or process and produce data)

MichiganTech Technology and Economic Development

Anatomy of a Patent

- Title
- Background
 - Field of invention
 - Description of related art
- Summary
- Description of drawings
- Description of preferred embodiment
- Claims

MichiganTech Technology and Economic Development

Claims

- Must particularly point out and distinctly claim the invention.
- What the invention “is”, not what it “does”.
- Describe the metes and bounds of the invention – Define the “property” similar to a real estate claim.

MichiganTech Technology and Economic Development

Example Claims

1. A grooming drum adapted for use with a snow grooming device, said drum comprising: an **elongated cylinder** including a central axis, said cylinder supportable by the snow grooming device for rotation about said central axis; a plurality of axially spaced apart and radially protruding **ribs** extending circumferentially around said cylinder, said ribs including circumferentially spaced apart **apertures**, the apertures of each rib being substantially aligned with the apertures of at least one other rib; and a plurality of elongated **cutting teeth**, each cutting tooth extending through aligned apertures of said ribs, said cutting teeth including a cross-sectional area, wherein said apertures are **larger than said cross-sectional** area to permit said cutting teeth to move with respect to said ribs as said drum rotates.

9. A snow groomer for use on a snow-covered landscape, said snow groomer comprising: a movable platform adapted to move in a forward direction; a prime mover mounted to said platform; a grooming drum rotatably mounted to said platform; and a power transmission assembly operatively interconnecting said prime mover with said grooming drum, wherein in response to operation of said prime mover, **said drum counter-rotates with respect to the forward direction** to agitate and groom snow on the snow-covered landscape.

MichiganTech Technology and Economic Development

Inventorship

- Inventors are those that came up with the inventive concepts described in allowed claims.
- Individuals that helped demonstrate the concept are not necessarily inventors. They must have contributed inventive concepts during the demonstration process.
- Inaccurately listing inventors can result in invalidation of a patent.

MichiganTech Technology and Economic Development

Important Considerations

- Public disclosure
 - results in forfeiture of foreign patent rights.
 - U.S. patent applications must be filed within one year of the disclosure date.
- Record keeping
 - accurate and verifiably dated records are very important in determining inventorship and priority in the event of competing applications in the U.S.

MichiganTech Technology and Economic Development

Patent Searching

- May be prospective or retrospective
- Ultimately best done by search firm at Patent Office.
- Search by:
 - Keywords
 - Assignees
 - Inventors
- Look at:
 - Description - relevant to prior art
 - Claims - relevant to freedom to operate
 - Drawings

MichiganTech Technology and Economic Development

Searching cont.

- Classification system assists in constraining necessary search space
- Example
 - Class 136 Batteries: Thermoelectric and Photoelectric
 - Subclass 243 photoelectric
 - .244 panel or array
 - ...246 With concentrator, orientator, reflector, or cooling means
 - ...247 Fluorescent concentrator

MichiganTech Technology and Economic Development

Simplified Patent Process

1. Disclosure prepared
2. Prior Art search
3. Market assessment
4. Patent prepared
attorney fees for prep
5. Patent filed - US PTO and PCT (global)
patent office filing fees

MichiganTech Technology and Economic Development

Simplified Patent Process (cont.)

6. Foreign National Filings (1-2 years)
7. Office actions
8. Response to office action
attorney fees for prosecution
9. Final office action
allowance of all or some claims
final rejection
10. Appeal

MichiganTech Technology and Economic Development

Proprietary Rights for Employees

- Employees are typically required to assign rights of inventions to their employer as a condition of employment.
- Assignment is typically for nominal consideration (although modest compensation programs are being developed).
- Agreements are not necessarily restricted to efforts on working hours.
- Agreements also may have “non-compete” clauses.

MichiganTech *Technology and Economic Development*

Invention Disclosure

- Document that describes the invention and documents its conception (priority).
- Should be signed, dated, and witnessed.
- Should be reasonably “enabling” – have a basic description of how to create the invention, including drawings.
- Supplement with notebooks and other documentation as necessary.

MichiganTech *Technology and Economic Development*

When should an invention disclosure be submitted

- As soon as you have developed the concept and have some assurance that it works and meets the criteria for novelty and non-obviousness.
- Documented dates of disclosure submission can be important if there are competing applications.

MichiganTech *Technology and Economic Development*

What can you do with a patent?

- A patent in and of itself is simply a document.
- The value in a patent exists in what it allows you to do (or exclude others from doing) and must be extracted either through a license agreement or using it to enhance the competitive position of your business.

MichiganTech *Technology and Economic Development*

Career Opportunities Related to Patents

- Patent Attorney
- Patent Agent
- Patent Engineer
- Licensing Manager
- Technology Portfolio Manager
- Inventor
- Entrepreneur

MichiganTech *Technology and Economic Development*

Additional Resources

- Web Resources
 - www.uspto.gov
 - www.delphion.com
 - www.patentcafe.com

Contact Information:

www.admin.mtu.edu/iptc

jrbaker@mtu.edu

487-2228

MichiganTech *Technology and Economic Development*